

back to where it all began.

ISER
XIII

CAMBRIDGE UK | 22-27 JULY 2018

03 ISER I – WHERE IT ALL BEGAN

05 ISER XII – BACK TO WHERE IT ALL BEGAN

07 LETTERS OF SUPPORT

14 LOCAL ORGANISING COMMITTEE

17 OFFICIAL SUPPORT

20 THE VENUE

28 SYMPOSIA ORGANISATION

33 THE BREEDING INDUSTRY IN NEWMARKET

35 WHY CHOOSE CAMBRIDGE?

37 THINGS TO DO IN CAMBRIDGE

38 THINGS TO DO IN SURROUNDING AREA

39 THINGS TO DO IN EAST ANGLIA

40 THE UK

41 INTERNATIONAL EQUINE REPRODUCTION SYMPOSIUM

ISER
XII

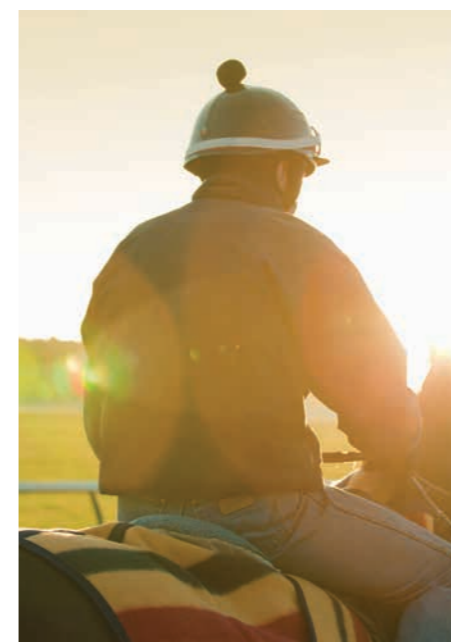

© Trevor Jones



Delegates who have attended every ISER (from left to right: Eric Palmer, Keith Betteridge, Robert Hillman, Ed Squires, Sidney Ricketts, Twink Allen)

FIRST INTERNATIONAL SYMPOSIUM ON EQUINE REPRODUCTION



From left to right: *Front row:* K. Kosiniak, I. W. Rowlands, R. V. Short, W. Bielański, Mrs K. Arbeiter, R. M. Moor, Mrs J. K. Barty, Virginia E. Osborne, K. Arbeiter, H. Tillmann, M. Vandeplassche, D. Mitchell, W. R. Allen, P. D. Rosedale, D. W. Holtan, J. S. Cosgrove, J. Hickman, Ann C. Chandley, J. D. Ansell, R. J. McEnery, M. J. Cooper, Mrs M. Cooper, P. W. Nathanielsz, C. H. G. Irvine, Margaret J. Evans, P. Hernández-Jauregui, Carole A. Samuel, Isabel A. Forsyth, R. C. Rous, A. W. Patterson; *Second row:* L. Jacob, F. T. Day, S. Kallander, J. M. Owen, J. K. E. Erskole, L. F. McManamny, M. C. Morrison, G. Mansfield, H. Williamson, Beatrice Jousset, E. Palmer, Miss Tillmann, W. Baier, R. Thein, P. S. Jackson, R. R. Pascoe, R. Burrows, A. D. Purvis, D. Codazza, Sally Spence, W. van der Holst, Patricia Ellis, M. Pollitt, J. P. Hughes, K. E. Gudsell, C. J. Roberts, D. P. Neely, G. Malnati, J. Morgan, H. Merkt, V. K. Ganjam, A. M. Nelson; *Third row:* I. Settergren, E. Tolksdorff, D. G. Williams, H. Kitchen, M. Varadin, R. S. Thornbury, R. E. Pattle, P. F. B. Williams, P. C. Belonje, C. H. van Niekerk, J. Spincemaille, H. Onuma, P. Wright, O. Sharma, K. Mason, F. Lagneau, P. Benazet, J. T. Bryans, E. H. Fallon, J. B. Hughes, R. E. S. Greenwood, W. P. Howey, E. Klug, A. M. Larsen, J. L. Hancock, D. R. McCullough; *Fourth row:* E. E. Swierstra, M. A. J. Azzie, W. J. Solomon, J. F. von Lepel, R. Moberg, J. E. Lowe, S. J. Burns, J. W. Evans, A. Zafracas, S. Yamauchi, Y. Nishikawa, Carol C. Alm, J. J. Sullivan, A. Littlejohn, W. G. Parker, A. Hennau, D. D. Hardy, G. H. Stabenfeldt, R. M. Kenney, G. R. Greenhoff, J. L. Voss, J. M. Bowen, J. I. Raeside, G. H. Arthur, J. P. O'Donnell, H. Heinze; *Back row:* B. W. Pickett, C. H. B. Marlow, D. G. L. Faull, H. Leuenberger, R. A. McFeely, R. B. Hillman, W. Jochle, D. M. Witherspoon, J. Thimonier, A. W. Marrable, P. Mauléon, T. M. Nett, W. D. Oxender, Patricia A. Noden, E. L. Squires, R. H. Douglas, D. C. Sharp, J. E. Cox, R. M. Liptrap, D. S. Irvine, K. J. Betteridge, W. E. Allen, S. W. Ricketts, P. F. Flood, R. G. Loy. (See p. ix for complete list of participants.)

Professor Twink Allen writes:

ISER I... WHERE IT ALL BEGAN

THE First International Symposium on Equine

Reproduction was held over 5 days in mid-July 1974, at King's College, Cambridge, with lectures in the famous Physiological Laboratory on the Downing Site. The Symposium arose from the frustrations experienced by Peter Rosedale, Doug Mitchell and Twink Allen when attending and presenting papers at the large International Congress of Animal Reproduction and AI (ICAR) held in a huge and cavernous town hall in Munich, Germany. Over a cup of coffee they bemoaned the lack of papers on, and audience interest in, horses in general and equine reproduction in



an organised tour party of 20 Australian and New Zealand stud vets who were the "life and the soul" of the party. It took some doing to get them back safely to their rooms and prevent them from having a swimming race at 2am in the River Cam after the black-tie final dinner in King's. This included drinking an 1879 port drawn from King's cellar by the late John Hickman, a Fellow of the College and a well-chosen member of the Local Organising Committee. This memorable evening followed

four and a half days during which 150 lectures were given in a very tightly timed programme, which set the tone of good, but practical, equine reproductive science and veterinary practice, combined with a fair portion of camaraderie and jollity, which has been the hallmark

of all the subsequent 4-yearly meetings. Twink Allen, Peter Rosedale and Idwal Rowlands edited (and often rewrote) all 150 manuscripts and these were published within a year of the Symposium as an 800 page Supplement of the Journal of Reproduction and Fertility. The Proceedings where much sought after and all 2500 copies were sold to make a handsome profit which helped greatly to create funding held by the International Committee Trust to provide travel scholarships for young scientists to attend subsequent Symposia around the world. In this way the International Symposium on Equine Reproduction was born and Cambridge was

work!

Just under 200 delegates from around the world attended the Symposium and this included

Where it all began.



© Trevor Jones



© Trevor Jones



© Trevor Jones

David Dugdale (Chairman of the Local Organising Committee) writes:

ISER XII... BACK TO WHERE IT ALL BEGAN...

FOLLOWING the first International Symposium in Equine Reproduction in Cambridge in 1974 subsequent symposia have been held in Davis, Sydney, Calgary, Deauville, Caxambu, Onderstepoort, Fort Collins, Kerkade and Lexington. The International Symposium has become a fixture in the research calendar. It is fair to say that knowledge in equine reproduction has advanced in leaps and bounds over the intervening years and this is in no small part due to the gathering every 4 years of the world leaders in equine reproduction. After a period of 44 years it is particularly appropriate that the Symposium should return to the University of Cambridge, the site of its inception.



Cambridge University recently reached a special milestone in its illustrious history. In 2009 it celebrated its 800th anniversary as an academic institution. These 800 years of academic endeavour have produced people, ideas and achievements that have transformed and continue to transform the worlds of science and letters. From the establishment of the fundamentals of physics by Sir Isaac Newton to the discovery of the structure of DNA by Crick and Watson, from the transformative thinking of great Cambridge philosophers, poets and artists, to the ground breaking work of its many Nobel Prize winners, Cambridge is the ideal environment for a scientific conference.

Combine this with the happy juxtaposition of Newmarket just 14 miles away. Newmarket grew from a small agricultural town under the patronage of King James I in the early 1600s and today is the world's best known centre of Thoroughbred training and breeding. In Newmarket science and practice in equine reproduction meet in happy harmony. The large number of well-run stud

farms enables veterinary reproductive medicine to be practiced at the highest level. Collaboration between scientists and veterinary practitioners is vital to move forward our understanding of horse breeding. Furthermore the continued evolution and globalisation of the Thoroughbred breeding industry presents unique

challenges. These include the present-day practice of "shuttling" stallions between Northern and Southern hemispheres and the growing tendency to cover very large numbers of mares by a single popular stallion.

Returning to Cambridge in 2018 will allow reflection upon and celebration of the substantial scientific achievements of the last 44 years and will concentrate minds on the many daunting challenges ahead. It is therefore highly appropriate that the Twelfth International Symposium on Equine Reproduction be held in Cambridge and thereby go

Back to where it all began.



© Trevor Jones

LETTERS OF SUPPORT

JUDDMONTE

Banstead Manor Stud, Cheveley, Newmarket, Suffolk CB8 9RD
Tel: +44 (0)1638 731115 Fax: +44 (0)1638 730592
Email: banstead@juddmonte.co.uk www.juddmonte.co.uk

PEHM/VJM

David Dugdale Esq, MRCVS
Newmarket Equine Hospital
Cambridge Road
Newmarket
Suffolk
CB8 0FG

28th October 2013

Dear David,

The International Symposium on Equine Reproduction 2018

Thank you for your letter of 1st October 2013.

I believe it is extremely important for everyone to try and bring the Symposium back to Cambridge, and demonstrate that the UK is at the forefront of equine reproduction.

I believe it is important for as many of the major Breeders as possible to show their support and any bid should not be reliant on the generosity of a chosen few.

With this in mind Juddmonte Farms would be prepared to commit to £10,000.

May I wish you every success with the bid.

Kind regards.

Yours sincerely,

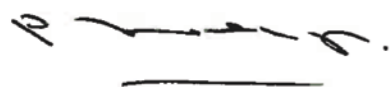

Philip E H Mitchell

Juddmonte Farms Limited
Registered Office: Banstead Manor Stud, Cheveley, Newmarket, Suffolk CB8 9RD
Company Registered in England & Wales No. 1746568

 **UNIVERSITY OF
CAMBRIDGE**
Department of Veterinary
Medicine

David J Dugdale Esq MRCVS
Managing Partner
Newmarket Equine Hospital
Cambridge Road
Newmarket
Suffolk
CB8 0FG UK

Professor JLN Wood
Alborada Professor of Equine And Farm Animal
Science
Head of Cambridge Vet School

26 September 2013

Dear David

International Symposium on Equine Reproduction in Cambridge in 2018

The Vice-Chancellor of the University of Cambridge, Professor Leszek Borysiewicz, has asked me to reply to you on his behalf to support enthusiastically the proposal for the next International Symposium on Equine Reproduction being held at the University of Cambridge.

As you know, the First International Symposium was held here in 1974 and it would be tremendous were the Symposium in 2018 to return to Cambridge after so long. The strong links between the University of Cambridge Veterinary School and the University's basic science departments, and the Equine Industry in the Newmarket would provide an ideal local environment for the Symposium. As you know, there are and have been many academics and students that work on issues relating to the equine industry, not least reproduction. Furthermore, holding this Symposium in Cambridge in 2018 should help to strengthen the relationships between the University and the Industry in Newmarket, which is only around 14 miles away – and should help to provide many opportunities for engagement with our clinical and post-graduate students and scholars.

There are many historic college venues in Cambridge that would be perfect for this sort of international event. The various colleges that offer conference venues include modern facilities, in the centre of the international scientific centre of Cambridge. Cambridge is an ideal setting for international conferences as it is close to London (45 minutes on the train) with all of its major transport hubs.

Please let me know if you require further information from me, or the Vice-Chancellor, at this stage.

Yours sincerely

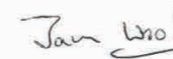

James Wood BSc BVetMed MSc MA PhD MRCVS DLSTH DipECVPH FSB
Head of Department of Veterinary Medicine and
Alborada Professor of Equine and Farm Animal Science

Madingley Road
Cambridge
CB3 0ES

Tel: +44 (0) 1223 764666
Fax: +44 (0) 1223 764667
Email: jlnw2@cam.ac.uk



The International Equine Reproduction Symposium Committee

Louise Holder
IERSC Secretariat
C/o The Hawthorns
7 Wings Road
Lakenheath
Suffolk, IP27 9HW

3 October 2013

Dear Ms Holder,

I am delighted to learn that Cambridge is bidding to welcome The International Symposium on Equine Reproduction in 2018.

I fully endorse this bid and I know that our partners within the England conference industry will deliver a magnificent and successful event for all of your delegates. England is one of the most dynamic and exciting global destinations and will be a popular choice for your delegates.

As the national tourism agency for England, VisitEngland will work closely with our colleagues in Cambridge, and nationwide, to ensure that delegates are given every assistance to make the most of their visit to England. Naturally, we hope that many will choose to extend their visit to experience the rich history, culture and countryside.

I am confident that if you choose Cambridge to become your host destination, not only will you be delighted with the business amenities and conference programme, but also the warm welcome that makes an event in England a wonderful and unforgettable experience.

Yours sincerely,

Handwritten signature of James Berresford
James Berresford
VisitEngland CEO

1 Palace Street | London SW1E 5HE
T: +44 (0)20 7578 1400 | F: +44 (0)20 7578 1401
visitengland.com/corporate | enjoyengland.com

VisitEngland incorporated under the Development of Tourism Act 1969 as British Tourist Authority



THE THOROUGHBRED BREEDERS' ASSOCIATION

Patron: Her Majesty The Queen

17th October 2013

Mr J S Crowhurst, MA, VetMB, MRCVS
Newmarket Equine Hospital
Cambridge Road
Newmarket
Suffolk CB8 0FG

Dear James,

Re: The International Symposium on Equine Reproduction 2018

I understand that you at the Newmarket Equine Hospital have formed a local Committee to bid on holding the International Symposium on Equine Reproduction in Cambridge in 2018. Members of the Thoroughbred Breeders' Association have all benefited hugely in the advances made, presented and published from each of the preceding ISERs and we strongly support the bid to have the Symposium returned to Cambridge, where the first one was held in 1974.

I understand that two additional conferences, one for reproductive Vets in practice and one for Stud Managers and workers, are to be held around the time of the Symposium in 2018, which will also benefit clinicians and our Members.

Cambridge has wonderful facilities for hosting such a conference and I know that the local Racing and Breeding Industry is going to support the bid wholeheartedly; Newmarket and its environs will give a very warm welcome to delegates during their excursions.

I wish you every success with the bid.

Yours sincerely,

Handwritten signature of Richard Lancaster

Richard Lancaster
Chairman

Stable House, 8 The Avenue, Newmarket, Suffolk, CB8 9AA
TELEPHONE 01638 661321
FAX 01638 665621
EMAIL info@thetba.co.uk
WEBSITE www.thetba.co.uk
VETERINARY REGISTRATION NO. 5409266-87
REGISTERED IN ENGLAND AND WALES COMPANY NO. 0591289
REGISTERED CHARITY NO. 1134291

Members' benefits

- Monthly Thoroughbred Owner & Breeder Magazine
Third Party Public Liability Insurance Cover
Enhanced Breeders' Prizes
Political Lobbying and Representation
Thoroughbred Stallion Guide
Stud Staff & Breeder Awards

Cheveley Park Stud Limited

Duchess Drive, Newmarket, Suffolk, CB8 9DD
Tel: 44 (0) 1638 730316 Fax: 44 (0) 1638 730868
E-mail: enquiries@cheveleypark.co.uk
Website: www.cheveleypark.co.uk



18th October 2013

D J Dugdale MRCVS
Chairman of the Local Organising Committee
ISER XII
Newmarket Equine Hospital
Cambridge Road
Newmarket
Suffolk CB8 0FG

Dear David

International Symposium on Equine Reproduction - Cambridge July 2018

I am writing to give strong support to the bid to host this Symposium in Cambridge in July 2018.

The contribution of academic and practical equine expertise in Cambridge and Newmarket offers a unique opportunity for progress in the management of Thoroughbred breeding. The UK breeding industry has benefited greatly from the scientific advances associated with the International Symposia held over the last 40 years, and Cheveley Park Stud look forward to further advances being made in the future.

Yours sincerely

C J Richardson
Managing Director

Registered Office: Duchess Drive, Newmarket, Suffolk, CB8 9DD. Registered No.1222930
Managing Director: C.J. Richardson Directors: Sir Michael Stoute, D.B. Thompson, P. Thompson, C.J. Dant

 UNIVERSITY OF
CAMBRIDGE
Pro-Vice-Chancellors' Office

Professor Jeremy K. M. Sanders FRS
Pro-Vice-Chancellor for Institutional Affairs

Louise Holder
IERSC Secretariat
C/o The Hawthorns
7 Wings Road
Lakenheath
Suffolk
IP27 9HW

17 September 2013

Dear Louise

International Symposium of Equine Reproduction, Cambridge, July 2018

I am writing to give strong support on behalf of the University for the bid to host this Symposium in Cambridge in 2018.

The Symposium was conceived by Professor Twink Allen in our Veterinary School, and was first held here in Cambridge in 1974. It has since flourished, having been held in many different countries all over the world, but it has not visited Europe since 2006 and it has not yet returned to its birthplace.

The combination of academic and practical equine expertise in Cambridge and Newmarket is surely unique, and the conference skills of the local teams are also truly outstanding, so you can be sure that an event held here will make a major contribution to equine reproductive science and also be a great success socially.

Yours sincerely

Professor Jeremy Sanders
Pro-Vice-Chancellor for Institutional Affairs

 Athena
SWAN
Bronze Award

The Old Schools
Trinity Lane
Cambridge CB2 1TN
Tel: + 44 (0) 1223 339655
Fax: + 44 (0) 1223 765693
Email: Jeremy.KM.Sanders@admin.cam.ac.uk
www.cam.ac.uk

LOCAL ORGANISING



MR DAVID DUGDALE
VETMB MA, CertEP, CertESM
MRCVS
Newmarket Equine Hospital,
Cambridge Road, Newmarket
CB8 0FG
T: +44 (0)1638 782000
E: david.dugdale@neh.uk.com

Following an upbringing in South Yorkshire, David went to Cambridge University in 1980 to study Veterinary Medicine. It was here that his interest in all matters equine was stimulated. Following graduation in 1986, David practiced as a veterinary surgeon in a mixed agricultural practice in rural Hertfordshire for two years, dealing with cattle, sheep, horses, dogs and cats. He then moved to Malton, North Yorkshire where he worked mainly with racehorses. In 1989, he moved to Newmarket where he is now resident.

David is the Managing Partner in Newmarket Equine Hospital a large, 30 vet practice dealing with Thoroughbred racehorses and breeding stock. He is also involved in the Tattersalls sales where he acts as veterinary advisor to the sales company and he attends as official veterinary surgeon at Newmarket Racecourse. In 1999 he was elected to the Council of the British Equine Veterinary Association and was President in 2008. He holds the post graduate RCVS Certificates in Equine Practice and Equine Stud Medicine and for several years was Chief Examiner for the RCVS Certificate in Equine Stud Medicine. He also acts as Veterinary Advisor to the Racehorse Owners' Association and is a member of the BHA Veterinary Committee.

David has lectured regularly at British Equine Veterinary Association courses for veterinary surgeons and also at the Thoroughbred Breeders' Association Stud Medicine Course each year. He is a lecturer at The National Stud Students Course and runs an annual course for veterinary surgeons in Newmarket Equine Hospital.

He has been Chairman of the Board of Trustees of the University of Cambridge Veterinary School Trust for several years. The aim of the Trust is to raise funds for the training and education of veterinary students.

He is married with four children and his leisure activities include horse riding, and gardening.



PROFESSOR W R (TWINK) ALLEN
CBE, SCD, FRCVS
The Paul Mellon Laboratory
of Equine Reproduction, 18
Woodditton Road, Newmarket,
Suffolk CB8 9BJ
T: +44 1638 666930
E: pml777@virginmedia.com

Twink graduated from Sydney Veterinary School in 1965 and completed a PhD degree under the supervision of Professor Roger Short FRS at Cambridge Veterinary School in 1970. He then founded, and remained until its closure in December 2007, Scientific Director of The Equine Fertility Unit, initially at The Animal Research Station in Cambridge and from 1989 at Mertoun Paddocks in Newmarket. He was elected to the Jim Joel Professorship of Equine Reproduction and awarded an ScD degree by Cambridge University in 1995, elected to a Professorial Fellowship of Robinson College in 1996, achieved Diplomate and Fellowship status in The Royal College of Veterinary Surgeons in 1986 and 2004 respectively, was made a Fellow of The Institute of Biology and The Royal Agricultural Society of England in 2002 and created CBE in 2001. Twink has been awarded Honorary Doctorate degrees by the Universities of Krakow, Gent and Helsinki. Since his retirement from the Cambridge Chair and the closure of The Equine Fertility Unit in December, 2007 he became the Scientific Director of the Paul Mellon Laboratory of Equine Reproduction in Newmarket where he is undertaking laboratory-based experimental studies on archived pregnant mare placental interface samples. He is also actively researching placental and gonadal structure and functions of African elephant, giraffe, zebra and wildebeest.

COMMITTEE



MR JAMES CROWHURST
VETMB BA MRCVS
Newmarket Equine Hospital,
Cambridge Road, Newmarket
CB8 0FG
T: +44 (0)1638 782000
E: james.crowhurst@neh.uk.com

James graduated from Cambridge Vet School in 1978 before working in mixed practice in Queensland, Australia, Hagyard Davidson McGee, Lexington and reproductive practice in Scone, New South Wales, Australia.

James joined Professor 'Twink' Allen at ARC, Cambridge for a year, helping him with his work including embryo transfer. He joined Greenwood Ellis and Partners in Newmarket in 1981 and became a partner in 1984 doing mixed work initially but concentrating on reproductive practice for the last 20 years. He was Chairman of the Newmarket Stud Farmers Association for five years and is currently Joint Veterinary Advisor to the Thoroughbred Breeders Association. James has attended the last five ISER conferences and is the co-author of reproductive papers with Professor Twink Allen and the EFU.



MR HUW NEAL
MA VETMB MRCVS
Newmarket Equine Hospital
Cambridge Road
Newmarket
CB8 0FG
T: +44 (0)1638 782000
E: huw.neil@neh.uk.com

Huw graduated from Cambridge in 1983 and came to Newmarket after two years in Thirsk. Most of his time is spent working with stud farms and National Hunt racehorses.

Huw's special interests include fertility evaluations in mares and stallions, foetal sex determination, laparoscopic investigation/treatment of fertility disorders and surgery of the reproductive organs.

ISER XII



**MR ANDREW
MCGLADDERY**
BVMS CertESM MRCVS
Rossdale Equine Hospital &
Diagnostic Centre, Cotton End
Road, Exning, Newmarket,
Suffolk CB8 7NN
T: +44 (0)1638 577754
E: andrew.mcgladdery@
rossdales.com

Andrew graduated from Glasgow University in 1985 with a degree in veterinary medicine and surgery. After a brief period in equine practice in Devon and then Kent Andrew joined Rossdale & Partners in 1988 as a Horserace Betting Levy Board resident in equine studies. This was for a three year period until 1991 under the guidance of Peter Rossdale and with a special interest in perinatology and ultrasonography. At the end of his residency he remained working on the stud farm side of the practice and became a partner in the practice in 1994. He is a holder of the RCVS certificate in equine stud medicine. He has co-authored a number of publications, presented at conferences and lectured around the world on a number of stud farm medicine related topics. Andrew was an ISER committee member for the Caxambu symposium.

Andrew's main areas of responsibility include stud farm medicine (thoroughbred and non-thoroughbred) and bloodstock sales, and also clinical referrals - especially those involving mare infertility investigation and hysteroscopy.



**MRS LOUISE
HOLDER**
7 Wings Road,
Lakenheath,
Suffolk
IP27 9HW
T: +44 (0)7813 218396
E: louise.holder@iseronline.org

For over 20 years Louise worked for Newmarket based company, R&W Communications, owned by Jan Wade. During her time there, she was involved in the organisation of numerous international conferences. These included the International Society of Veterinary Perinatology Conference, World Congress of Veterinary Anaesthesia, Equine Infectious Diseases Conference and the International Conference of Racing Analysts and Veterinarians, to name a few.

She has been actively involved with the IERSC for over 20 years and, since 2008, has been the Secretariat for the Committee and continues in this role.

After being made redundant in 2010, Louise now works for worldwide veterinary pharmaceutical company, Virbac.

**ISER
XIII**



OFFICIAL SUPPORT

NEWMARKET EQUINE HOSPITAL

Cambridge Road, Newmarket CB8 0FG

Tel: +44 (0)1638 782000

Email: referrals@neh.uk.com

www.newmarketequinehospital.com

This unique centre of excellence is the largest and most modern equine hospital in Europe, gathering all specialties of the equine veterinary profession in a state of the art facility and focusing on personalised high quality veterinary service. Completed in September 2008 by Greenwood Ellis & Partners, NEH is located by the 'stallion statue' roundabout, near the July racecourse and the National Stud, at the centre of the racing headquarters with the two racecourses, the training grounds, racing stables and stud farms all within proximity.

The practice consists of 12 Partners, three Associates, ten Assistant Vets and four interns who do a wide range of equine work including extensive stud practice on high profile studs all over East Anglia. Several Partners are also dedicated to Horse in Training work locally as well as major trainers as far afield as Manton and Middleham. In addition, Newmarket Equine Hospital Referrals are involved in

medical and orthopaedic cases from all over the world. The practice also offers consultancy services on a national and international basis.

The philosophy of Newmarket Equine Hospital is to provide clients with veterinary services that are tailored to their individual needs and requirements. We provide total veterinary cover for Newmarket Races on both courses. Partners are principal veterinary advisers to The Thoroughbred Breeders' Association, the Racehorse Owners' Association and Tattersalls in Newmarket and attend all major national and international Thoroughbred Sales. Advisory work also includes countries as far as Japan, Turkey, Europe and America. David Dugdale has been President of the British Equine Veterinary Association.



Newmarket Equine Hospital

ROSSDALES EQUINE HOSPITAL & DIAGNOSTIC CENTRE

Cotton End Road, Exning, Newmarket,
Suffolk CB8 7NN

Tel: +44 (0)1638 577754

Email: practice@rossdales.com

www.rossdales.com

Rosssdales was established in 1959 by Peter Rosssdale who took the bold decision to set up his own practice on the Dullingham Road just outside Newmarket. The practice soon moved to Beaufort Cottage Stables just off Newmarket High Street, which is still home to the ambulatory service that predominantly serves many of the most important stud farms and thoroughbred training yards in the Newmarket area and East Anglia. In recent years, the ambulatory team has also increasingly catered for pleasure and competition horse clients. In 2012 Rosssdales merged with a well known three vet equine practice that looks after pleasure and competition horses in the Hertfordshire area to create Rosssdales Herts. Partners in the ambulatory team are also involved in advising clients purchasing bloodstock at major Thoroughbred Sales in Europe and the USA. Beaufort Cottage Laboratories, the highly prestigious specialist equine clinical pathology laboratory service for UK and EU vets is also based here.

Since 1991 orthopaedic and medical diagnostic services have been undertaken in Exning, just outside Newmarket, at Rosssdales Equine Diagnostic Centre. In 1997 this was augmented by the building of Rosssdales



Equine Hospital to cater for the ever-increasing surgical case-load referred both by the ambulatory practice and vets from all over the UK. Ten years later in 2008 a new Diagnostic Centre building was completed on the same site, housing sophisticated MRI and CT imaging suites and a standing surgery unit. On both occasions the practice was honoured to have the buildings opened officially by Her Majesty the Queen.

Today, Rosssdale & Partners is the largest equine veterinary practice in Europe and provides world-class facilities employing 38 veterinary surgeons and over 100 support staff. The practice offers a highly personalised, high quality and 'state of the art' service to horse owners and referring veterinary surgeons. There are five surgical and two medical diplomates, as well as specialists in reproduction and pathology.

The practice has provided three Presidents of the British Equine Veterinary Association, a President of the British Veterinary Association and of the World Equine Veterinary Association. It has also had two editors of the Equine Veterinary Journal, including the current incumbent.



CONFERENCE CAMBRIDGE

12C King's Parade, Cambridge CB2 1SJ

Tel: +44 (0)1223 768740

Email: enquiries@conferencecambridge.com

www.conferencecambridge.com

Conference Cambridge is the official venue finding service of the University of Cambridge, the Cambridge Colleges and other unique properties in the City and surrounding areas.

Their aim is to find the perfect venue for any event.

The University and its Colleges need to maximise their income through commercial conferencing, residential and catering activity when their facilities and staff are not needed for their core educational purpose. Conference Cambridge was established in 1998 to act as the official marketing and enquiry point for the University, its Colleges and other venues in Cambridge and the local area.

The Cambridge Venue Company Limited was formed in 2009, for which Conference Cambridge is the trading name. In addition to representing 31 Colleges, their portfolio includes other academic venues including The Pitt Building and Madingley Hall, alongside city hotels and other unusual facilities.

Subscribing venues pay an annual fee, based on their previous year's conference business and the number of undergraduate bedrooms available. Associate Venues were introduced in July 2013, extending the portfolio to approx. 50 venues.

The office handles 2,750 enquiries per year worth £25-30m and brings in around £4-5m business annually for the venues in the portfolio.

The Conference Cambridge Team:

Kelly Vickers, Office Manager,
Judith Sloane, Assistant Manager.

OFFICIAL TRAVEL AGENT/CAR HIRE PREMIER TRAVEL

10 Rose Crescent, Cambridge CB2 3LL

Tel: +44 (0)1223 500007

Email: rco@premier-travel.co.uk

Premier Travel would be pleased to offer assistance to any delegates wishing to book pre and post conference travel to Europe and other destinations within the UK; London Tours, Scottish Tours etc. Car hire can also be arranged through Premier Travel.



CHURCHILL COLLEGE THE VENUE

UNIQUELY amongst the Cambridge Colleges, Churchill College was founded specifically to pursue excellence in the teaching and research of science, engineering and technology. This underpins our culture of informality, flexibility and search for continuous improvement. The architecture pays reference to the traditional vernacular of inter-linked courtyards, but the style is decidedly contemporary; the open parkland setting where visitors are free to stroll or play games on the grass is inspiring and relaxing; and the presence of the world famous Churchill Archive Centre, offers the chance to supplement traditional conference activities with talks and exhibitions about some of the most significant political leaders of the 20th century.

Churchill College, which received its Royal Charter in 1960, is the national and Commonwealth memorial to Sir Winston Churchill. It is the embodiment of his vision of

how higher education can benefit society in the modern age. Like the thirty other colleges in Cambridge University, it is committed to outstanding academic achievement; more than twenty of its members have won the Nobel Prize. While it focuses especially on science, engineering and technology, its teaching and research also reflect the intense interest in the arts and humanities of Sir Winston himself, whose own Nobel Prize was for literature. And it builds bridges from academe to business and the professions.

Churchill occupies one of the largest sites of any Cambridge college, over forty acres close to the University's expanding science, engineering and mathematics' departments. Playing fields adjoin the spacious lawns and quiet courts of the College, whose buildings, faithful to the traditional collegiate pattern, were the first major work of modern architecture in the University — deemed by Pevsner "the best of the new". Churchill has generous facilities for social,

cultural and recreational life — a vital part of the educational experience. Among these are a splendid theatre, a superb music centre, elegant halls and galleries, a fitness suite, and tennis and squash courts. Other amenities include the Sheppard and Wolfson Flats for family accommodation and the Møller Centre, which provides first-class residential and conference facilities for academic and business leaders from around the globe.

The Churchill Archives Centre houses the papers of Sir Winston, Baroness Thatcher and over 600 of their contemporaries — politicians, diplomats, civil servants, military figures, scientists and engineers. It is one of the most important repositories in the world for research into recent history and a unique resource for studying the art of leadership in diverse spheres. As well as acting as a magnet to scholars, the Centre is developing an extensive outreach programme based on digital technology.

Modern, well equipped meeting rooms, an

accessible and peaceful parkland setting, and the gravitas of a Cambridge college combine to provide a venue where delegates can achieve their work objectives and also find space to relax and network with colleagues.

Churchill College has been hosting academic and corporate conferences for nearly 50 years, during which delegates from around the globe have been welcomed. The College is proud of this history, and always focuses on the needs of the present and future, and so is fully equipped to broadcast conferences to the world through video conferencing and podcasting, and many of our rooms have integrated data projection and sound reproduction.

The College Events Team understand that every meeting or conference has different needs, and therefore offers flexibility of space to cater for large multi-site conventions, residential and day conferences, product launches, board meetings and more.





Sir Winston Churchill statue



WOLFSON HALL

max capacity: 300 seated

An air-conditioned theatre with seating for up to 300. A full proscenium stage offers front projection along with theatrical lighting, a surround sound system, data connections and a dedicated AV technician on hand to ensure every presentation is memorable for its professionalism and visual impact.

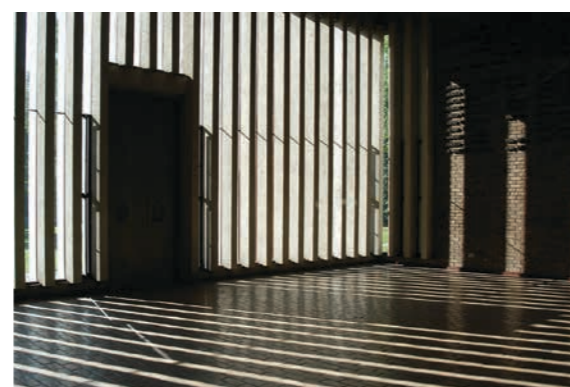

JOCK COLVILLE HALL

Max capacity: 80 seated/80 standing

**Classroom: 50 | Exhibition: 75 | Theatre: 80
Reception: 100 | U-Shape: 25**

This purpose-built exhibition hall, which can also seat 80 people for a lecture-style meeting, is a dramatic, high-ceilinged space with imposing bronze entrance doors opening onto the College lawns.

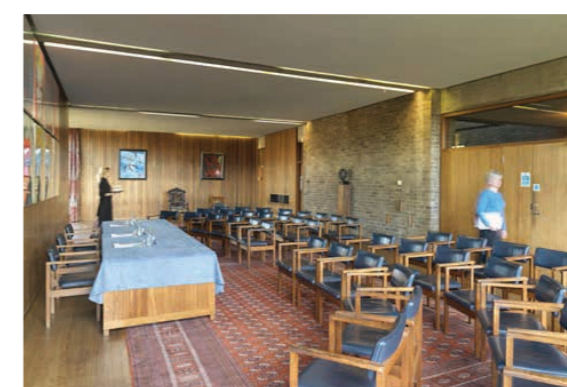

FELLOWS' DINING ROOM

Max capacity: 70 seated/80 standing

**Boardroom: 40 | Classroom: 48 | Theatre: 70
Reception: 80 | U-Shape: 33**

A very flexible space, with dual aspect windows and natural daylight illuminating the display of contemporary art adorning the walls. The juxtaposition of traditional and contemporary culture gives this room a vibrant ambiance reflecting its purpose as the primary debating space of the College Fellowship. This room can accommodate both board meetings on a single large table or presentations with theatre style seating, and is the perfect setting for a private dinner.

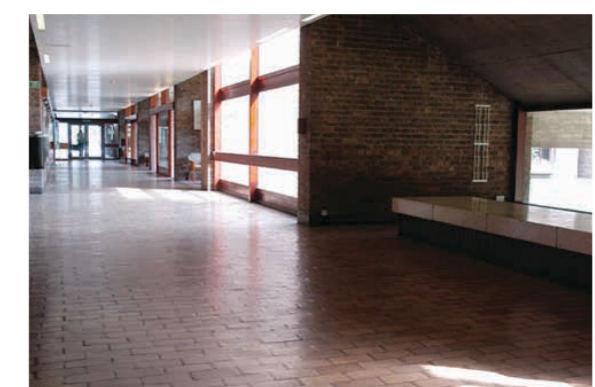

MAIN CONCOURSE

A spacious walkway that leads from the Porters' Lodge to the heart of the College. In summer the wall of windows can be opened to enable guests to walk out onto the lawns and seating areas, or rest in the shade of the magnificent oak tree planted at the College's foundation. The Concourse is perfectly suited for combining delegate registration, informal receptions and exhibitions. The café-bar with free WiFi access can be found at one end of the Concourse and forms a central networking space for delegates during their stay.

CHURCHILL COLLEGE

Storey's Way, Cambridge CB3 ODS

Tel: +44(0)1223 336233

Email: conferences@chu.cam.ac.uk

www.churchillconferences.co.uk

COLLEGE SITE PLAN

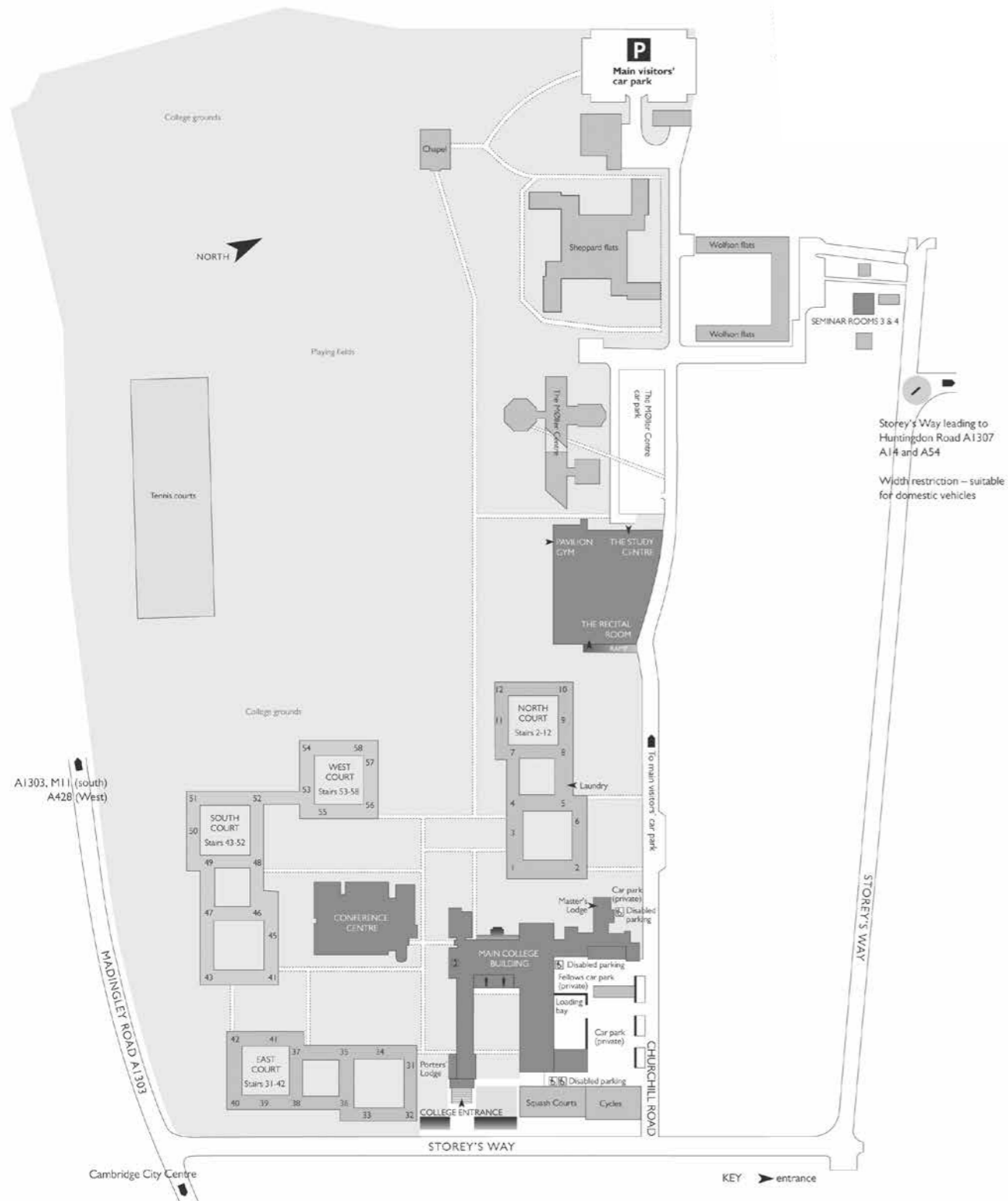

CONFERENCE CENTRE

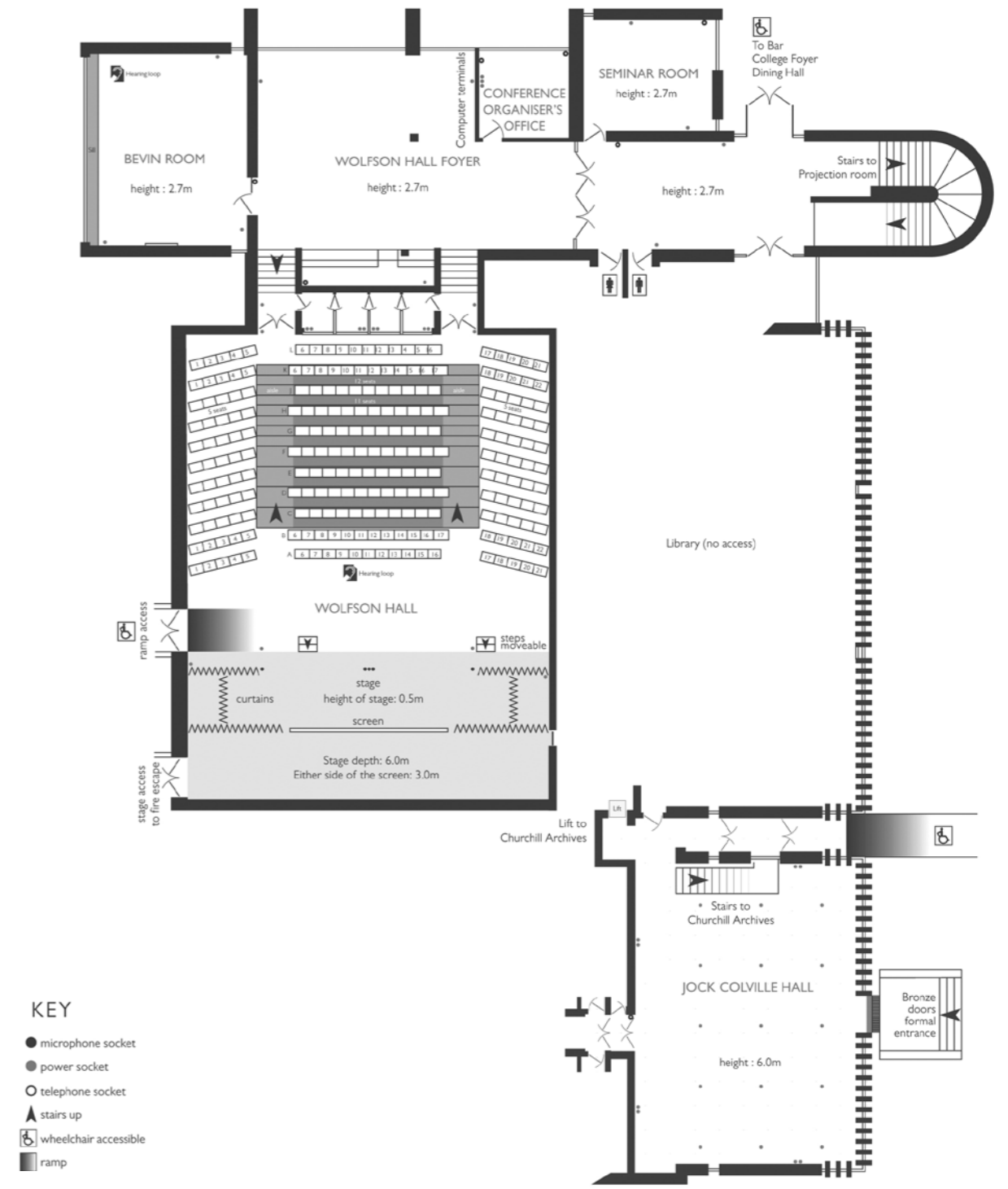

Wolfson Hall | Jock Colville Hall | Wolfson Hall Foyer | Conference Organiser's Office | Seminar Room



CHURCHILL CONFERENCES LIMITED
 Storey's Way, Cambridge CB3 0DS | Tel: +44(0)1223 336233 | Fax: +44(0)1223 336174
 Email: enquiries@churchillconferences.co.uk | www.churchillconferences.co.uk

ACCOMMODATION AT CHURCHILL COLLEGE

Accommodation on site for a maximum of 419 people. Encircling the main College buildings, many of these rooms offer views over the inner courtyards or surrounding grounds and gardens.

The light, generously proportioned rooms combine the functional needs of a business traveller, including a spacious desk and free broadband Internet access, with home comforts such as tea & coffee and toiletries.

There are 130 en-suite bedrooms and 250 standard bedrooms with shared bathrooms. All standard bedrooms feature a wash hand basin in the room. Up to 50 bedrooms are available for twin occupancy.

Additional en-suite accommodation is available at the Møller Centre which lies within the College grounds, or at neighbouring colleges, all of which are located within strolling distance on Storey's Way. The Accommodation Office will be happy to source supplementary accommodation for your event as part of our inclusive service.



ISER XIII

ALTERNATIVE ACCOMMODATION

Cambridge and the surrounding areas have a number of hotels to suit all tastes and requirements from luxury hotels to functional stopovers.

FOUR STAR OPTIONS

CAMBRIDGE CITY HOTEL

Downing St, Cambridge CB2 3DT
cambridgecityhotel.co.uk

Step inside the Cambridge City Hotel and discover a remarkable space that thoughtfully combines comfort and warmth with elegant style. Upon arrival, visitors can immediately soak up the welcoming atmosphere. From here on in, we will provide a professional, personable, round-the-clock service that will put you at ease and have you feeling rested - however long the journey here has been.

CAMBRIDGE UNIVERSITY ARMS

Regent St, Cambridge, CB2 1AD
www.devere-hotels.co.uk

In the heart of medieval Cambridge, set back from the hustle and bustle of the town and bathed in green lawn lies this rather special historic hotel.

DOUBLETREE BY HILTON

Granta Place Mill Lane, Cambridge CB2 1RT
doubletree3.hilton.com

The DoubleTree by Hilton Cambridge is surrounded by the historic sights of Cambridge and is situated in enviable position on the banks of the River Cam, boasting some of the best views Cambridge has to offer but only a few minutes' walk from the centre of the city. With first class facilities for all occasions, business and pleasure, the hotel offers 122 contemporary bedrooms, a stylish Penthouse Suite, Riverside Brasserie, Twist Bar & Terrace and LivingWell health club.

BUDGET OPTIONS

PREMIER INN CAMBRIDGE NORTH (GIRTON)

Huntingdon Road, Girton, Cambridge CB3 0DL

www.premierinn.com

Our Cambridge North (Girton) Premier Inn has everything you'd expect, free parking, incredibly comfy beds in every room and an onsite Beefeater restaurant serving freshly cooked chargrilled food. Cambridge city centre is only 3 miles away. Cambridge train station is also 3 miles away.

ARUNDEL HOUSE HOTEL

Chesterton Road, Cambridge CB4 3AN
www.arundelhousehotels.co.uk

Beautifully located overlooking the river Cam and open parkland the hotel is only a short walk across the park, known as Jesus Green, to the city centre and the wealth of fascinating architecture for which Cambridge is famous. The hotel, which is privately owned, has been formed from a terrace of particularly fine late nineteenth century Victorian houses. The facade and elegantly proportioned interiors have been carefully preserved while still allowing the hotel to offer all the modern services which discerning travellers now demand. All of the hotel's 103 bedrooms have private facilities en suite, with either a bath, a shower or bath and shower. All rooms also have tea and coffee making facilities, television, radio, hairdryer and a direct dial telephone with an automatic wake up alarm facility. Free Wifi is available in all areas.

SYMPOSIUM ORGANISATION

ISER
XII

ISER
XII

THE ITINERARY DELEGATES DRAFT PROGRAMME

DAY	TIME	EVENT
Sunday 22nd July 2018	Afternoon	Registration
	Evening	Welcome reception/evening meal
Monday 23rd July 2018	All day	Symposium
	Evening	Free to explore Cambridge
Tuesday 24th July 2018	All day	Symposium
	Evening	Workshops
Wednesday 25th July 2018	Morning	Symposium
	Midday	Newmarket Tour
	Evening	Evening entertainment
Thursday 26th July 2018	All day	Symposium
	Evening	Workshops
Friday 27th July 2018	All day	Symposium
	Evening	Banquet

ACCOMPANYING PERSONS DRAFT PROGRAMME

DAY	TIME	EVENT
Sunday 22nd July 2018	Afternoon	Registration
	Evening	Welcome reception
Monday 23rd July 2018	All day	Suffolk Wool Towns Tour
	Evening	Free to explore Cambridge
Tuesday 24th July 2018	Morning	Free morning
	Afternoon	City Walking Tour
Wednesday 25th July 2018	Morning	Free morning
	Midday	Newmarket Tour
	Evening	Evening entertainment
Thursday 26th July 2018	All day	Visit to Ely Cathedral/Oliver Cromwell's House
Friday 27th July 2018	Morning	Botanical Gardens Tour/Chauffeured Punting
	Afternoon	Free afternoon
	Evening	Banquet

BUDGET

DELEGATE RATES:	COSTING (Sterling)	COST (US Dollars) exchange rate of 0.62
Presenting delegate rate	£295.00	\$475.81
Non-presenting delegate rate	£395.00	\$637.10
Accommodation with shared bathrooms (per person)*	£360.00	\$580.65
Accompanying persons' delegate rate	£200.00	\$322.58

*£24 (\$38)/person/night for premium ensuite accommodation

EXPENDITURE	COSTING (Sterling)	COST (US Dollars) exchange rate of 0.62
2 smaller rooms (approx 100 seats) for workshops x 2 evenings	£960.00	\$1,548.39
Poster display area for approx 40 posters (rotated halfway through symposium)	£0.00	\$0.00
Hire of poster boards x 40 x 5 days @£15/board	£600.00	\$967.74
Committee meeting room on Sunday for 15 people (including refreshments)	£350.00	\$564.52
Day delegate rate £53.50 x 275 x 5 days (£1,031.25 discount for Wed half day)	£72,531.25	\$116,985.89
WELCOME RECEPTION - SUNDAY X 300		
Evening meal 300 @ £25/person	£7,500.00	\$12,096.77
Drinks: sparkling wine on arrival and wine with meal	£3,000.00	\$4,838.71
WEDNESDAY SOCIAL EVENT X 300		
Tour of local stallion stud (sponsored)	£0.00	\$0.00
Tour of the National Horseracing Museum (£15/person)	£4,500.00	\$7,258.06
Evening meal at National Horseracing Museum £35/person	£10,500.00	\$16,935.48
Drinks	£3,000.00	\$4,838.71
Entertainment	£2,000.00	\$3,225.81
Coach hire	£2,220.00	\$3,580.65
BANQUET AT KINGS COLLEGE - FRIDAY X 300		
Room hire	£1,700.00	\$2,741.94
Gala dinner x 300 (canapes, 3 course dinner, cheese)	£23,799.00	\$38,385.48
Pre-dinner drinks, wine with meal, port	£7,500.00	\$12,096.77
The King's Men (gold package) + meals	£1,000.00	\$1,612.90
Symposium Website	£2,500.00	\$4,032.26
Design of logo	£400.00	\$645.16
Group photo	£1,000.00	\$1,612.90
Publication of proceedings x 300 (400 pages hardbound)	£13,000.00	\$20,967.74
Travel and registration costs for Honorary Chair and spouse	£2,000.00	\$3,225.81
Conference badges, bags etc	£2,500.00	\$4,032.26
Accommodation x 6 nights x 300 @ £60/person	£108,000.00	\$174,193.55
Accompanying persons' programme x 25 (four events)	£2,500.00	\$4,032.26
VAT	£8,500.00	\$13,709.68
Contingency 5%	£16,000.00	\$25,806.45
TOTAL	£297,560.25	\$479,935.89

INCOME	COSTING (Sterling)	COST (US Dollars) exchange rate of 0.62
150 presenting delegates includes registration, most meals and social functions, proceedings	£44,250.00	\$71,370.97
125 non presenting delegates includes registration, most meals and social functions, proceedings	£49,375.00	\$79,637.10
Sponsorship/fundraising meetings	£100,000.00	\$161,290.32
Accompanying persons' programme registration fee £200 x 25	£5,000.00	\$8,064.52
Accommodation (6 nights @ £60/night x 300)	£108,000.00	\$174,193.55
TOTAL	£306,625.00	\$494,556.45

SURPLUS	£9,064.75	\$14,620.56
----------------	------------------	--------------------

WEBSITE

There will be an official conference website which will have the capacity of accepting secure online registrations.

FUNDRAISING ACTIVITIES

The Local Organising Committee will seek financial support for ISER XII in a number of ways.

1. A conference will be held before the Symposium for practising equine veterinary surgeons. This fee paying meeting will use speakers from the main Symposium on up-to-date practical aspects of equine reproduction.
2. A conference for horse breeders will be held before the Symposium at a Newmarket venue. This will again be a fee paying event using speakers from the main Symposium who will concentrate on new developments relevant to breeders.
3. Sponsorship has been sought from a number of large breeders based in Newmarket, together with local racing and breeding bodies and we have already received firm generous commitments. Pharmaceutical companies with an equine reproduction interest will be offered the opportunity to support the Symposium, as will international equine veterinary hospitals.

THE ORGANISATION

TRANSPORT TO THE VENUE

BY AIR

International flights are now available from Cambridge International Airport, which is only a few minutes journey from Churchill College. Darwin Airline offer onward connections from its flights to Amsterdam, Paris, Geneva and Milan, through to Etihad Airways' hub Abu Dhabi and beyond. Destinations from Cambridge include Australia, the Indian Ocean, Asia, Africa and the Far East. Flights to and from the USA are also now available through Air France.

London Stansted airport, located 30 miles to the South of Cambridge, has easy access by train, coach, or car (M11). London Heathrow, London Gatwick & Birmingham International Airport are also within easy reach of Cambridge.

Exclusive delegate discount on Darwin Airline

In conjunction with Cambridge International Airport and Darwin Airline we're pleased to be able to offer all ISER delegates discounted travel on Darwin Airline routes in and out of

Cambridge International Airport. Destinations currently served by Cambridge International Airport are: Paris, Milan, Amsterdam and Geneva. Conference Cambridge would be pleased to arrange a discount code on request.

Private Transfers

A local airport transfer company, Airport Lynx would be pleased to offer a booking facility for transfers to and from all UK airports to Cambridge. Airport Lynx also operate a shuttle bus service for delegates arriving into Cambridge International Airport. Booking for the shuttle service is via their web site – see below.

Airport Lynx

1c, Flintbridge Business Park, Flint Lane, Ely Road, Waterbeach, Cambridge CB25 9QZ
Book Online: www.airportlynx.co.uk/index.html
Email: info@airportlynx.co.uk
Tel: +44(0)01223 440040

BY TRAIN

There is a fast and frequent rail service from London King's Cross & London Liverpool Street through to Cambridge.

BY ROAD

From the South & from London, Cambridge is a short trip up the M11 motorway. From the north, the A1 and M1 link to the A14 dual carriageway straight to the city, and from the east and west, the A14 again takes you to Cambridge.

BY COACH

National Express operates coach services to Cambridge from major towns & cities throughout the U.K. There are frequent coach services from both Central London, and London Stansted Airport through to the city.

THE BREEDING INDUSTRY IN NEWMARKET

NEWMARKET is surrounded by natural heathland and under the patronage of King James I in the early 1600s, it became an ideal venue to race horses. Stud farms soon sprang up in the surrounding countryside and today Newmarket is a world famous centre for the breeding, training, racing and selling of Thoroughbreds.



© Trevor Jones



© Trevor Jones



Market Square



Punts on the Backs and King's

In 2013 some 13,500 acres in and around Newmarket were involved in horse breeding. Thirty-eight stallions covered 3,176 mares and 1,847 foals were born. Newmarket Heath, managed by the Jockey Club Estates, comprises 2,500 acres. It includes 50 miles of turf gallops, 14 miles of artificial tracks and it is used daily by 2,500 horses. Newmarket also boasts two racecourses, each with a straight mile in the course. Newmarket is also home to Tattersalls, the oldest bloodstock auctioneer in the world and the largest in Europe. Founded in 1766 by Richard Tattersall, today it offers over 10,000 Thoroughbred horses for sale annually.

Where there are horses there are veterinary surgeons and Newmarket is home to a large number of veterinary surgeons. The two largest specialist equine practices are Newmarket Equine Hospital and Rossdale & Partners. Newmarket is also home to the Animal Health Trust.



© Trevor Jones

WHY CHOOSE CAMBRIDGE?

HERE ARE TEN GOOD REASONS TO CHOOSE CAMBRIDGE!

- 1 Cambridge is not just a conference destination; it offers visitors a unique experience that cannot be found anywhere else in the world.
- 2 Cambridge has an excellent central location with great access, less than an hour from London & several international airports, plus it is compact and easy to get around.
- 3 Cambridge offers a calm, comfortable, distraction free location, where your delegates can focus on the meeting's agenda and then enjoy unusual spaces for break-outs and refreshments in immaculate gardens or quiet cloisters that are perfect for relaxing or networking.
- 4 Today's event planners want to offer so much more than straight presentations; Cambridge has the venues, the outside space, the ambience, the technical ability, the people, the culture, the imagination and 800 years of experience to bring any event to life.
- 5 There is no better way to experience Cambridge than from the inside of a magnificent College.



King's from Great St Marys



DNA Molecule

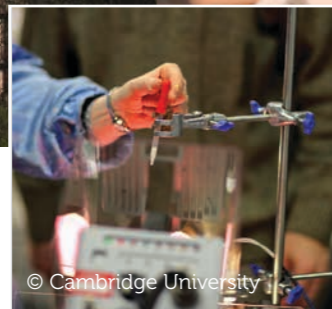

© Cambridge University

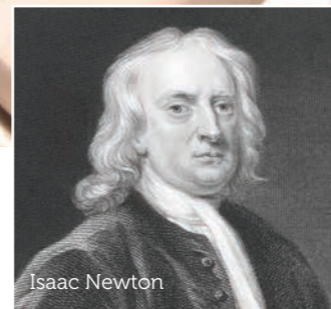

Isaac Newton

© Cambridge University



Botanic garden in Cambridge

6 Cambridge is the quintessential English destination. Our world-famous Colleges offer visitors a unique and inspiring mix of spaces for conferences, meetings and events. Ancient courts and halls sit alongside contemporary purpose-built centres brimming with the latest technology, where excellent service and delicious cuisine create a special ambience that only an academic venue can.

7 With 800 years of history, you can tread in the steps of our famed alumni – from Isaac Newton and Charles Darwin to Stephen Hawking, William Wordsworth, Samuel Pepys to Stephen Fry and Prince Charles and Jeremy Paxman to David Mitchell.

8 Cambridge is easy to reach: 30 minutes from Stansted Airport by train, or road; 45 minutes from London King's Cross train station, adjacent to St Pancras International, less than an hour from Harwich and just minutes from the main M11 motorway.

9 Historically, international events hosted in Cambridge attract greater delegate numbers than other destinations; it's so much more than a conference destination. Interesting landmarks, museums and galleries give delegates the opportunity to enjoy a rich and varied social programme too.

10 Our portfolio offers a choice of 36 architecturally stunning venues, with something to suit every taste and budget. Compared with hotel options, our venues offer a unique experience at great value without any compromises.



THINGS TO DO IN CAMBRIDGE

CAMBRIDGE GUIDED TOURS

- Punting Tours
- Ghost Tours
- Fitzwilliam Tour
- Parker Library Tour
- Cambridgeshire Wine School Tasting Sessions
- Cambridge Food Tours
- Quick Sketch Tour
- Cambridge Bike Tours
- Cambridge America Cemetery and Memorial
- Cambridge University Museums
- Cambridge University Botanic Garden
- Kettle's Yard
- The Centre for Computing History



Abbey Gardens
Bury St Edmunds



Ely Cathedral



Newmarket

THINGS TO DO IN SURROUNDING AREA

Visit the Suffolk town of Newmarket, about 14 miles east of Cambridge and the world renowned home of horse racing. Enjoy a day or evening at the races, visit the horseracing museum or watch the horses gallop on the heathland surrounding the town.

Further to the east is Bury St Edmunds, an ancient market town with 12th C. Abbey ruins, award-winning gardens and historic streets bustling with shops, restaurants and cafés.

Approximately 16 miles to the north of Cambridge lies, Ely, one of England's most beautiful small cities - dominated by its spectacular cathedral. Once an island surrounded by marshes, take time to explore the narrow streets lined with historic buildings, such as the former home of Oliver Cromwell.

THINGS TO DO IN EAST ANGLIA

East Anglia offers everything from beach holidays, rural escapes and cultural experiences all within easy reach. Our coastline is endless and unique, from the breathtaking sands of north Norfolk to quaint Suffolk pebbled beaches and the family fun of Essex's coastal towns. An array of historic cities, towns and villages are there to explore. Places to visit in East Anglia include; stately homes and gardens, engaging museums, unique family attractions, festivals, galleries, nature reserves, coast, countryside, cultural cities, excellent shopping, fish and chips, award-winning food producers and restaurants, skinny dipping, fruit picking, crabbing... and the list goes on.



Norfolk



The Races



Southwold

All sounds too much? Well, you can always decide to rebel, kick off your shoes, sit back and enjoy a pint of local ale as you watch the sun set and the tide roll in.

Visit East of England attractions offer great days out to suit all ages, with a wide and varied range of attractions, activities, food and drink, events and shopping.

Visit one of our amazing treasure houses, or discover Britain's largest collection of cathedrals. Re-live the area's rich history at fantastic museums, then come back up to date with state-of-the-art galleries. Enjoy the spectacular colours of some of Britain's finest gardens.

Visit attractions in East Anglia for family fun, travel through time (from dinosaurs to Norman castles), jump aboard a real steam train, ride a scary rollercoaster at the seaside, or go on a wildlife safari. Get back to nature at country parks and bird reserves. See our talented craftspeople at work, then relax with tours at vineyards and breweries.



London

THE UK

Britain is full of contrasts; whichever direction you travel you will find a wide variety of landscapes and diverse cultures to explore. England, Wales, Scotland and Northern Ireland are all unique countries with their own customs, cultures and tradition.

Excursions can be organised through Roots Travel, 16 Bermuda Road, Cambridge CB4 3JX. www.roots-travel.co.uk

Roots' tours are tailor-made for travellers who wish to discover Britain's fascinating history and experience its unique culture.

We will show you more of the places we visit, revealing a modern Britain imprinted upon a picturesque land with a rich historic past.

Why not visit:

- London
- Bath & Stonehenge
- Stratford & the Cotswolds
- York
- Edinburgh, Loch Ness & the Scottish Highlands



Lands End



Strathclyde



Stonehenge

INTERNATIONAL EQUINE REPRODUCTION SYMPOSIUM

AIMS OF THE SYMPOSIUM

The prime responsibility of the IERSC is to organise the International Symposium on Equine Reproduction (ISER) that is held over a six-day period every four years.

These single weeks of internationalism, common focus, a sharing of all sessions by all delegates, and convivial social activities have proved of inestimable value to the advance of equine reproduction; we are proud of the spirit of friendship and collaboration that the meetings have engendered.

THE SYMPOSIUM

Each Symposium is limited to 275 delegates, lasts 6 days (Sunday-Friday) and includes a half-day non-scientific programme/excursion on Wednesday afternoon and evening workshops on Tuesday and Thursday.

The Symposium consists of 75 poster presentations and 75 oral presentations. Registration fee for this conference is kept at a minimum and includes accommodation and most meals.

ISER COMMITTEE

The IERSC is composed of a Chairman, Treasurer, Editor and at least eight other members, with designated numbers from Asia and Oceania, America and Europe to ensure international representation. The Committee is supported by a non-elected secretariat. The Committee meets every two years, at the International Symposium and at a mid-way meeting. Committee members serve initially for eight years, and are eligible for re-election for no more than two additional consecutive four-year terms. Nominations for new members are solicited at each Symposium. Nominations are put forward, to the Committee, by an existing member once the nominee has agreed to stand for election and serve for at least eight years. Election is by the Committee prior to the mid-way meeting.

CURRENT ISER COMMITTEE MEMBERS

Dr Marco Alvarenga
 Professor Christine Aurich
 Dr Barry Ball
 Dr Eduardo Gastal
 Dr Pat McCue
 Dr Sue McDonnell
 Dr Angus McKinnon
 Dr Lee Morris, Local Committee Chairman
 Dr Dale Paccamonti
 Professor Harald Sieme
 Professor Tom Stout, Committee Chair
 Dr Edward Squires, Editor
 Dr Walter Zent

ISER WEBSITE

www.iser-online.org

PREVIOUS SYMPOSIA

ISER XI – Hamilton, New Zealand 2014
 SER X – Kentucky, USA 2010
 ISER IX - Kerkrade, the Netherlands 2006
 ISER VIII – Fort Collins, Colorado, USA 2002
 ISER VII – Onderstepoort, South Africa 1998
 ISER VI – Caxambu, Brazil 1994
 ISER V – Deauville, France 1990
 ISER IV – Calgary, Canada 1986
 ISER III – Sydney, Australia 1982
 ISER II – Davis, USA 1978
ISER I – Cambridge, UK 1974



SISTER
XVII